

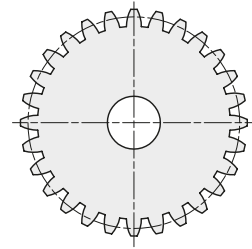

## RUOTE DENTATE CILINDRICHE TEMPERATE AD INDUZIONE CYLINDRICAL GEARS WITH HARDENED TEETH

**MODULO 3**

ANGOLO DI PRESSIONE **20°**

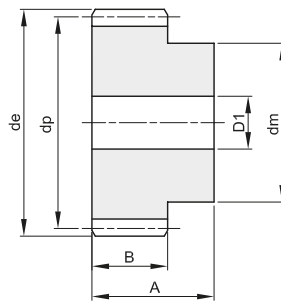

A	B
50	30

Materiale: Acciaio C45

Z	codice	de	dp	dm	D1	Kg.
12	402030012	42	36	27	12	0,28
15	402030015	51	45	35	12	0,47
18	402030018	60	54	45	14	0,72
20	402030020	66	60	45	14	0,84
24	402030024	78	72	50	16	1,18
25	402030025	81	75	60	16	1,39
30	402030030	96	90	60	16	1,85
36	402030036	114	108	70	20	2,62
40	402030040	126	120	80	20	3,31

Z	codice	de	dp	dm	D1	Kg.



## RUOTE DENTATE CILINDRICHE TEMPERATE AD INDUZIONE CYLINDRICAL GEARS WITH HARDENED TEETH

**MODULO 4**

ANGOLO DI PRESSIONE **20°**

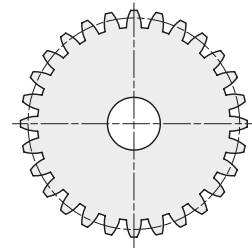
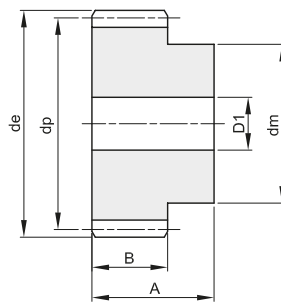

A	B
60	40

Materiale: Acciaio C45

Z	codice	de	dp	dm	D1	Kg.
12	402040012	56	48	35	14	0,63
15	402040015	68	60	45	14	1,05
18	402040018	80	72	50	16	1,47
20	402040020	88	80	60	16	1,90
24	402040024	104	96	75	20	2,79
25	402040025	108	100	75	20	2,98
30	402040030	128	120	75	20	4,06
36	402040036	152	144	80	25	5,63

Z	codice	de	dp	dm	D1	Kg.